



2561 Lac De Ville Blvd, Town of Brighton

Rochester, NY 14618 | Medical Office Building | FOR LEASE

Lac De Ville Medical Office Suites

Welcome to Lac De Ville Medical Building, a medical center located in the Town of Brighton (Rochester, NY). This state-of-the-art facility is home to some of the top medical professionals in the area.

Centrally located, just 2.5 miles from Strong Memorial Hospital, directly north of Clinton Crossings Medical Complex on Lac de Ville Blvd. off Westfall Road.

Current care providers include Zoneci Medical, Limitless Physical Therapy, and MacDonald Audiology on the main floor, while the second floor is home to University of Rochester's Primary Care offices of Westfall Pediatrics and Artemis Health.

Suite 100, which is 4,203 SF, will be available for a new medical practice in 2026.

For Sale: \$17.00 per SF

Lease Type Triple Net

Property Type: Medical Office

Square Feet: 4,203 SF; 1st Floor

Year Built: 1996

Year Renovated: 2022

Acreage: 2.16

Parking: 80 cars

Zoning: BE-1 Office

PHOTOS





Floor Plan

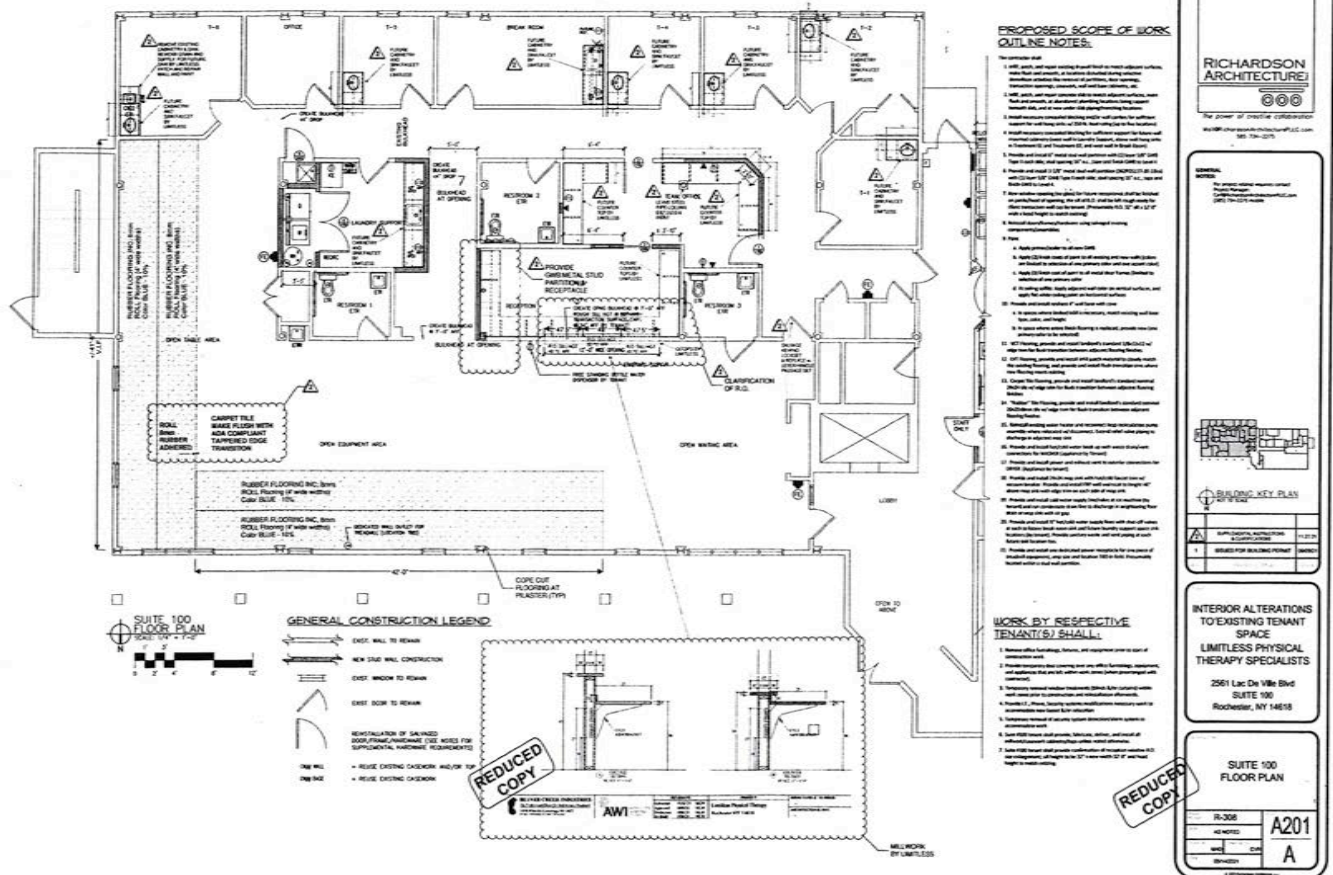

James (Jim) P. Pappas
President, Lic. Real Estate Broker

900 JEFFERSON ROAD, SUITE 203
ROCHESTER, NY 14623
(585) 424-6007
EM: JPAPPAS@CCIM.NET
WWW.JIMPAPPAS.NET

TRUSTED | RELIABLE | EXPERIENCED



For more than 30 years



James (Jimmy) T. Pappas
Licensed Real Estate Salesperson